

Uncontrolled when printed

Supersedes GERT8000-HB21 Iss 4 with effect from 04/12/2021

This document is withdrawn with effect from 02/12/2023



GERT8000-HB21

Rule Book

Handbook 21

## Safe work leader (SWL) blocking a line

Issue 5



September 2021

Comes into force 04 December 2021

**Published by:**

**RSSB**

**The authoritative version of this document is available  
at [www.rssb.co.uk](http://www.rssb.co.uk)**

**Contents approved by Traffic Operation and  
Management Standards Committee.**

**For information regarding the Rule Book, contact:  
<https://customer-portal.rssb.co.uk>**

**First issued December 2014**

**Issue 5, September 2021**

**Comes into force 04 December 2021**

**© Copyright 2021**

**Rail Safety and Standards Board Limited**

	<b>Page</b>
<b>1</b> Arranging to block a line	<b>2</b>
<b>2</b> Blocking the line	<b>10</b>
<b>3</b> Granting the line blockage	<b>13</b>
<b>4</b> During the line blockage	<b>13</b>
<b>5</b> Giving up or suspending the line blockage	<b>14</b>
<b>6</b> Sharing a line blockage	<b>16</b>

# 1 Arranging to block a line

## 1.1 When a line must be blocked

If as described in handbook 20, it is necessary to block a line, you must carry out the instructions shown in this handbook.

## 1.2 Agreeing the arrangements

You must agree all of the following with the signaller.

- The line to be blocked.
- The nature of the work.
- The locations between which the work will take place.
- The amount of time needed to do the work.
- The time after which permission can be given for the line blockage to start.
- Which signals will be kept at danger or block markers at which the route will be closed to protect the activity, including those in both directions on a single or bi-directional line.
- Any additional protection needed.
- If the work will take place beyond points that need to be used for train movements.
- The arrangements if single line working is taking place.
- The arrangements to apply at each level crossing.

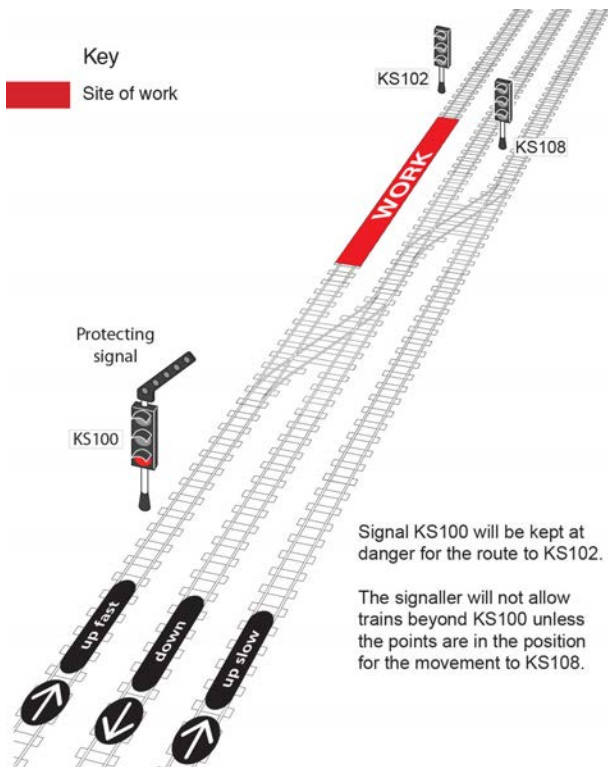
### **1.3 Working beyond points**

If the work will take place beyond points that need to be used for train movements, as shown in diagram HB21-1 or diagram HB21-2, the signaller will not allow a train to approach those points unless they are in the correct position to protect the work.

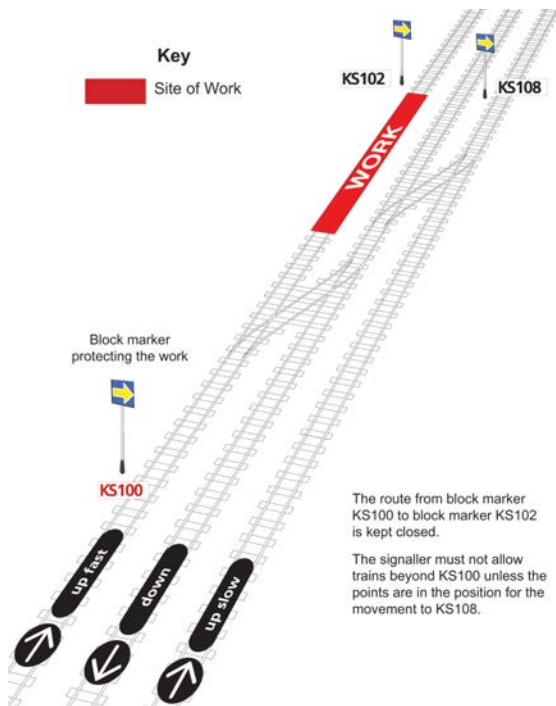
### **1.4 Working close to the protecting signal or protecting block marker**

Normally your site of work must not be closer than 200 metres to the protecting signal or protecting block marker. If work that will affect the safety of the line must be done within this distance, you must tell the signaller and the following must apply.

- The previous signal must be kept at danger or the route kept closed at the previous block marker.
- Trains may go beyond that signal only as shown in diagram HB21-3 and diagram HB21-5.
- Trains may go beyond that block marker only as shown in diagram HB21-4 or diagram HB21-6.

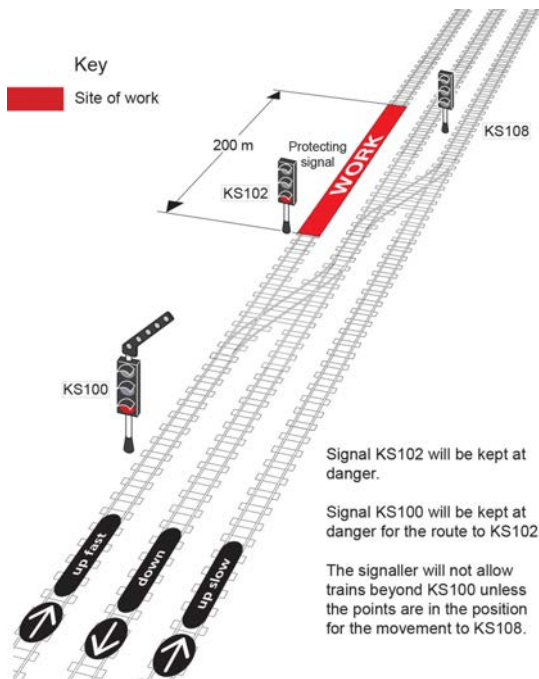


**Diagram HB21-1 Work taking place beyond points that will be used**



## Diagram HB21-2

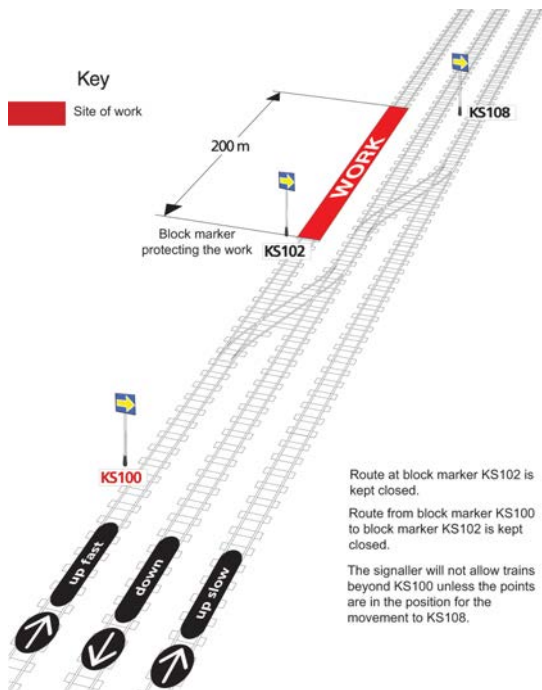
### Work taking place beyond points that will be used



### Diagram HB21-3

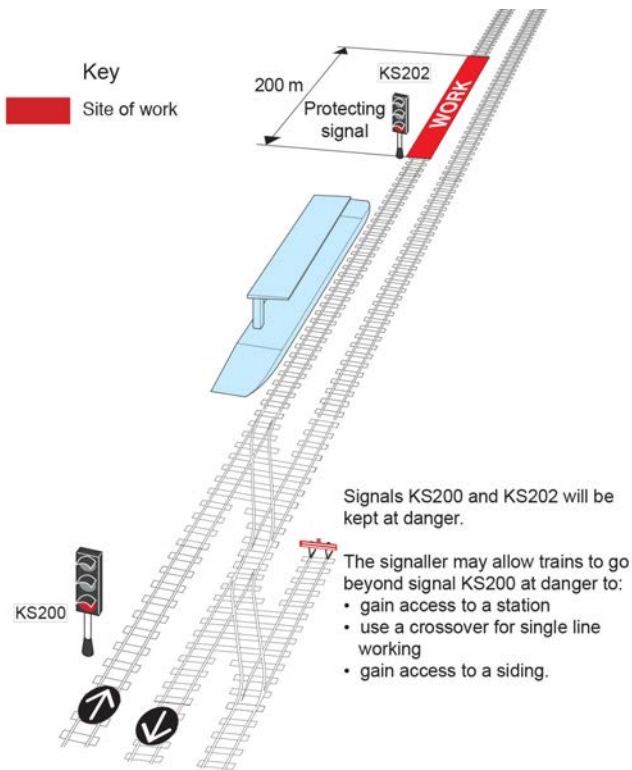
## Work taking place close to the protecting signal

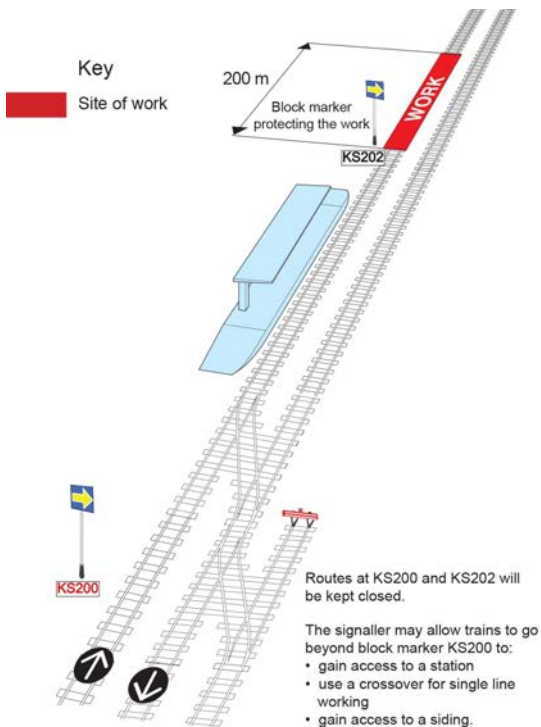




## Diagram HB21-4

### Work taking place close to the protecting block marker

**Diagram HB21-5****Work taking place close to the protecting signal**



## Diagram HB21-6

### Work taking place close to the protecting block marker

## 2 Blocking the line

### 2.1 Recording the details

You must complete a line-blockage form (NR3180).

You must read your entry to the signaller to confirm that it is correct.

The signaller will tell you when the protecting signal has been placed to danger or the route closed at the protecting block marker and will confirm that the signal will be kept at danger or the route kept closed.

You must then arrange for the additional protection if it is necessary.

### 2.2 Additional protection

You must arrange for at least one of the following additional protection arrangements, as shown in sections 2.3 to 2.9, to be provided on the line to be blocked whenever this is possible. However, you must always do so if the work will affect the safety of the line.

You must agree with the signaller what additional protection will be provided. The signaller will not give you an authority number until the additional protection is in place.

### 2.3 Disconnecting signalling equipment

You must ask the signaller to arrange for signalling equipment to be disconnected by the signalling technician to protect the line that is to be blocked.

## **2.4 Operating a lock-out device**

You can use a lock-out device as long as both of the following apply.

- You are competent to use the device.
- The device will protect the portion of line you are blocking.

## **2.5 Using a track circuit operating device**

Where authorised in the *Sectional Appendix*, you can use a track circuit operating device (T-COD) as long as the signalling equipment is working normally.

The work that is to be carried out must not affect the correct operation of the track circuit concerned.

You must get the signaller's permission before a T-COD is placed on the line.

You must tell the signaller when the T-COD has been applied.

## **2.6 Remotely-activated track circuit operating device (T-COD)**

Where authorised in the *Sectional Appendix*, you can use a remotely-activated track circuit operating device (T-COD) as long as the signalling equipment is working normally.

The work that is to be carried out must not affect the correct operation of the track circuit concerned.

You must get the signaller's permission before you activate the T-COD.

You must tell the signaller when you have activated the T-COD.

## **2.7 A single line staff or token**

You must get the staff or token from the signal box or from the token instrument not at a signal box.

You must follow local instructions if the signal box closes and the staff or token is needed or when it is returned.

## **2.8 Detonator protection**

You must arrange for detonator protection to be placed at the protecting signal or block marker or clear of any points or through crossings beyond.

Detonator protection is three detonators placed on the same rail, 20 metres (approximately 20 yards) apart with a possession limit board (PLB) placed at the first detonator.

You must do this in both directions if:

- you are working on a single or bi-directional line
- single line working is in operation on the line concerned.

## **2.9 Engineering possession reminder (EPR)**

Where authorised in the *Sectional Appendix*, you must ask the signaller to apply the EPR to protect the line that is to be blocked.

## 3 Granting the line blockage

The signaller will not grant the line blockage to you until the portion of line concerned is clear of all trains unless one of the following applies:

- Where authorised, you and the signaller can be sure that all trains have passed beyond your site of work.
- A train has become disabled or is at a stand, and will make no further movements until the line blockage is given up.

When you are both sure that the details on your NR3180 form are correct and all the arrangements have been carried out, the signaller will give you an authority number.

You must record the authority number on your NR3180 form. You may now treat the line blockage as granted.

## 4 During the line blockage

### 4.1 Protection at the site of work

When you have been given the authority number, you must place a red flag or red light on the approach to the site of work if:

- the work will affect the safety of any approaching train, or
- a group is working.

You must make sure that the red flag or red light is placed in the four-foot where it will be clearly visible to the driver of a train approaching on that line.

You must do this in both directions if:

- you are working on a single or bi-directional line
- single line working is in operation on the line concerned.

## **4.2 Handing over to another COSS or SWL**

When handing over to another COSS or a SWL, you must explain the details of the line blockage to the new COSS or SWL and give them the NR3180 form.

The new COSS or SWL must sign the NR3180 form.

# **5 Giving up or suspending the line blockage**

## **5.1 When the line blockage is to be given up or suspended**

When the line blockage is to be given up or is to be suspended, you must:

- make sure that any work that is to continue does not need a line blockage
- remove any red flag or red light that has been placed in the four-foot
- remove any T-COD or detonator protection that you have used as additional protection arrangements as shown in section 2 of this handbook.



If you have the staff or token as shown in section 2.5, you must:

- return the staff or token to the signal box at either end of the section, or
- return the token to an instrument that is not at a signal box.

If additional protection was provided by a disconnection as shown in section 2.3, after you have told the signaller that the line blockage is no longer needed or suspended, you must ask the signaller to get the signalling technician to reconnect the equipment.

If additional protection was provided by a remotely-activated T-COD, you must not deactivate this until after you have told the signaller that the line blockage is no longer required or suspended.

## **5.2 If the line blockage cannot be given up or suspended at the planned time**

As soon as you become aware that it will not be possible to give up or suspend the line blockage at the planned time, you must tell the signaller:

- the reason why
- what time you expect to give up or suspend the line blockage.

## **5.3 When the line blockage is to resume**

When the line blockage is to resume after being suspended, you must again carry out the instructions shown in this handbook.

The signaller will give you a new authority number, but you can continue to use the same NR3180 form.

However, if the line to be blocked or the protection arrangements are different, you must complete a new NR3180 form.

## **6 Sharing a line blockage**

If there are two or more COSSs, IWAs or SWL who need a line blockage at the same place and same time, a Protection Controller (PC) must be appointed to take overall control of the shared line blockage.

You must sign the NR3180 form unless it has been previously planned that it will not be necessary and you and the PC are aware of what is to happen.

When you hand over to another SWL or a COSS, the new SWL or COSS must give their name to the PC.

If the PC hands over to another PC, the new PC must give you their name.

Uncontrolled when printed

Supersedes GERT8000-HB21 Iss 4 with effect from 04/12/2021

This document is withdrawn with effect from 02/12/2023



Contact <https://customer-portal.rssb.co.uk>  
Tel +44 (0) 20 3142 5300  
Twitter @RSSB\_rail  
Web [www.rssb.co.uk](http://www.rssb.co.uk)

Rail Safety and Standards Board Limited  
The Helicon  
One South Place  
London  
EC2M 2RB